



**BENJAMIN
STEVENS.**
estate agents



26 Methuen Close, Edgware, HA8 6HA

Asking Price £350,000

A well presented two bedroom first floor maisonette in this quiet residential cul-de-sac.

Accommodation comprises two bedrooms, reception room, kitchen, bathroom

Features include a long lease and private garden.

Call Benjamin Stevens now to arrange a viewing!

Living Room



Second Bedroom



Kitchen



Bathroom



First Bedroom



Garden



Floor Plan

Approx Gross Internal Area
51 sq m / 544 sq ft

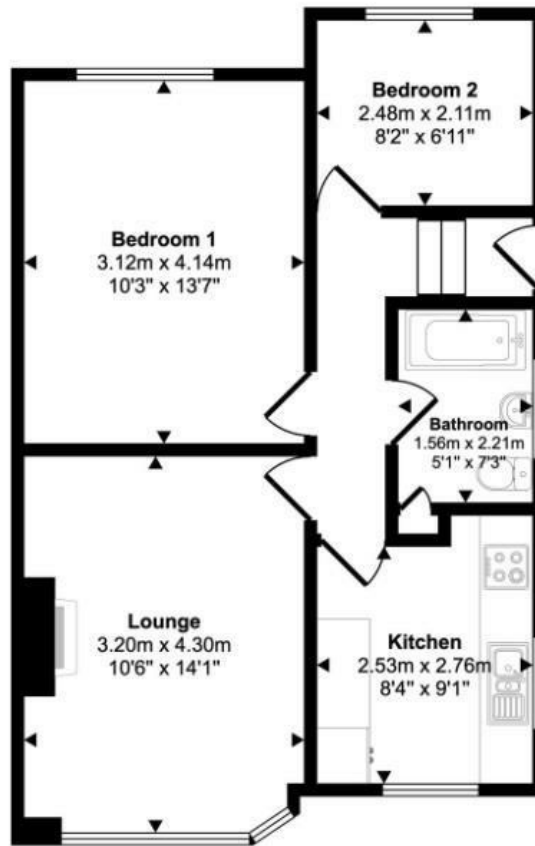

First Floor

Area Map

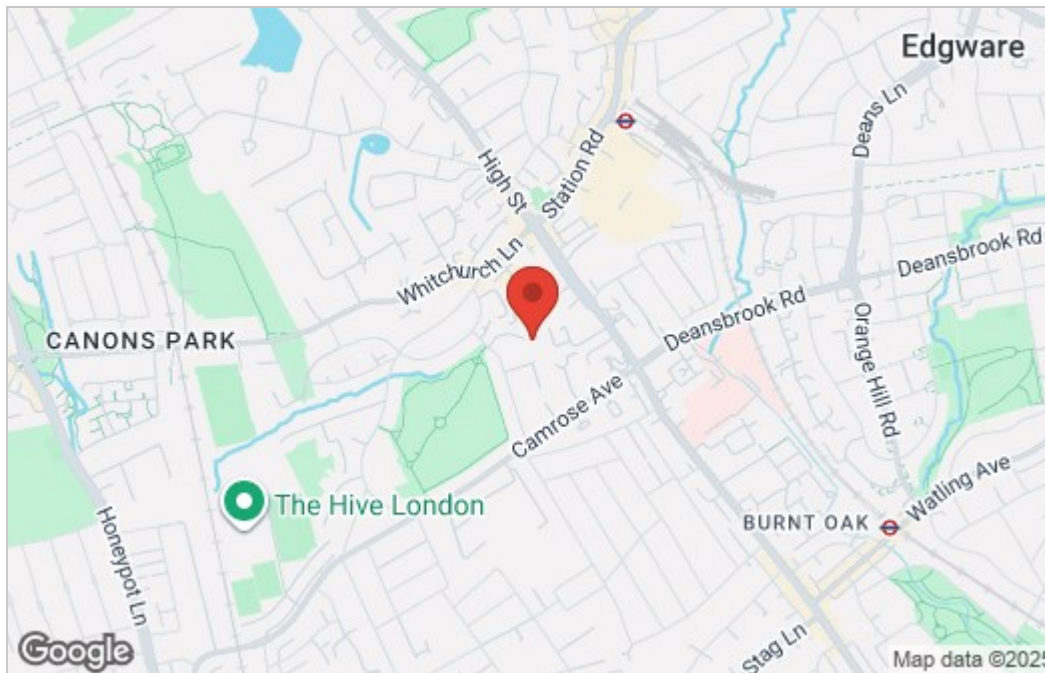

Energy Efficiency Graph

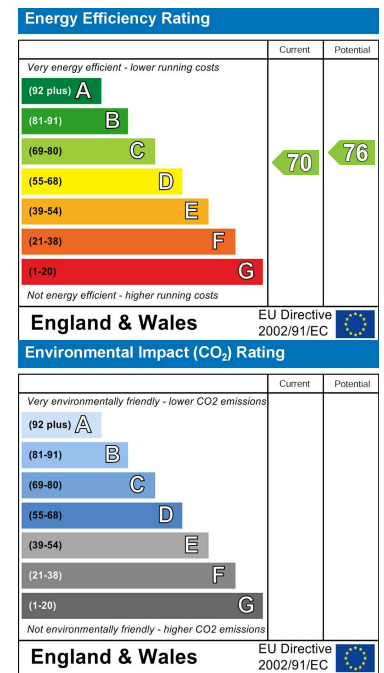

These particulars, whilst believed to be accurate are set out as a general outline only for guidance and do not constitute any part of an offer or contract. Intending purchasers should not rely on them as statements of representation of fact, but must satisfy themselves by inspection or otherwise as to their accuracy. No person in this firm's employment has the authority to make or give any representation or warranty in respect of the property.



Edgware Office- 194 Station Road, Edgware, HA8 7AT. Tel: 020 8958 1118
 Bushey Heath Office- 59 High Road, Bushey, WD23 1EE. Tel: 020 8950 7777
www.benjaminstevens.co.uk